

DOES YOUR ROOM MEASURE UP?

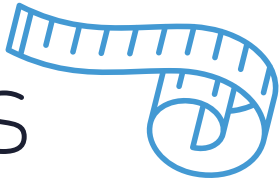

Don't ever underestimate the importance of an accurate measurement of your kitchen space – you don't want to be left with a new kitchen that doesn't fit! We can help you put your mind at rest with our measurement guide below, or even arrange a professional measure.

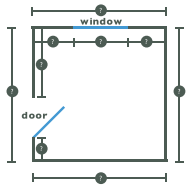

IMPORTANT:
MEASURE AND DRAW
THE POSITION OF ANY
DOORS OR WINDOWS.

- 1** To start, measure the outline of the room by measuring the walls, between each corner.
- 2** Measure anything that sticks out, such as pillars, shadow walls, pipes, etc. Also make sure to measure the distance between floor to ceiling, and include any bulkhead dimensions. Mark all of them carefully on your drawing.
- 3** Measure and draw up any windows or doors, including their widths, heights and depths of sills or reveals. Very importantly, make a note of the height of the window from the floor, as this will indicate if your benchtop is also your windowsill.
- 4** Check the position of power outlets, light switches, aircon or security switches. Measure the distance from a corner and mark it clearly on your drawing. If you are prepared to have these moved, make a note of where they could go.
- 5** Last but not least, measure and mark where your water supply comes in and where the waste is. You'll need to know if the waste pipe goes out of the wall or goes straight into the floor, especially if you're going to include a dishwasher.

